



+ Design & Ergonomics

MEDISSIMA's equipment and accessories are within easy reach for users. Its smooth surfaces facilitate cleaning and disinfection.

+ Medical gas casing

The innovative design of the medical gas casing and its integration to the front, ease the installation and maintenance. Retractable flap has been designed in the respect of MEDISSIMA's aesthetics.



TECHNICAL FEATURES

Front view

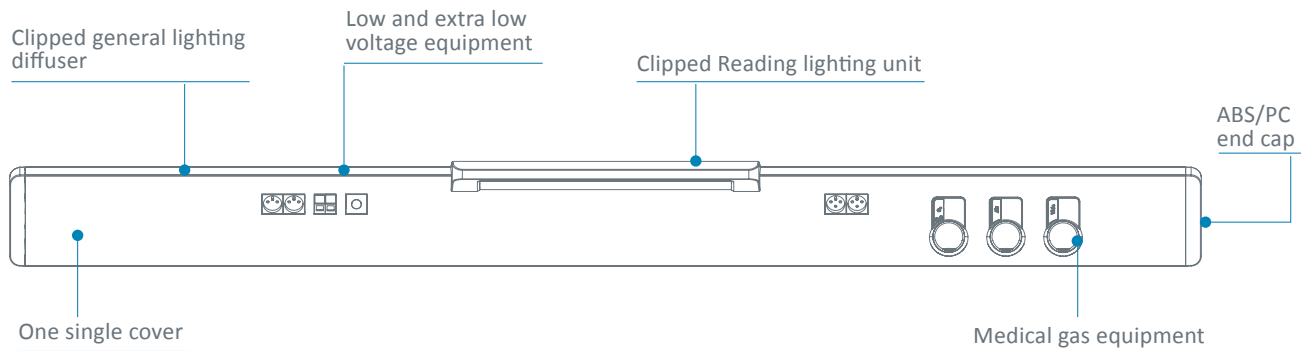

Cross-section

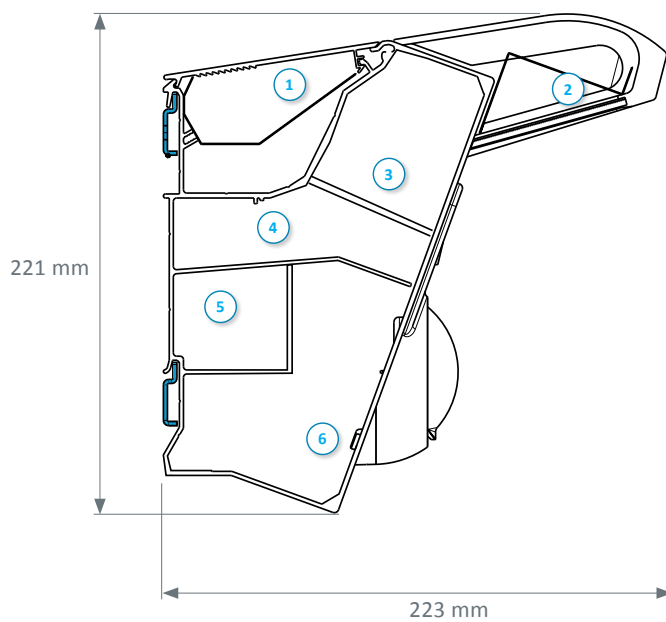

- ① Night orientation and general lighting compartment
- ② Reading lighting unit
- ③ Electrical equipment
- ④ Low voltage compartment
- ⑤ Extra low voltage compartment
- ⑥ Medical gas compartment

Colours

| | White RAL 9016 | Grey RAL 7035 | Grey RAL 7040 |
|--------------------|-------------------|------------------|------------------|
| Aluminum profile | ● | ● | |
| Medical gas casing | ● | | ● |
| End caps | ● | | ● |
| Lighting unit | | | ● |

FUNCTIONALITY

Custom made Medissima offers good modularity thanks to its configuration and its integration into care area. It is convenient for installation and maintenance.

Power supply

MEDISSIMA is designed to be fed :

- From the wall (A)
- From the ceiling, by a riser (B)
- From the side through an extra duct (C)

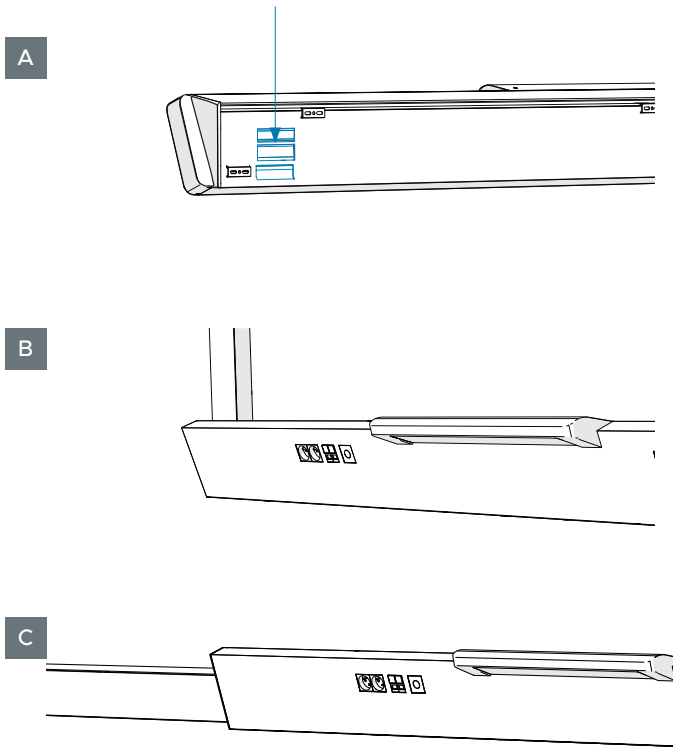

Installation & maintenance

The wall mounting system with an easy locking procures a real time saving during installation.

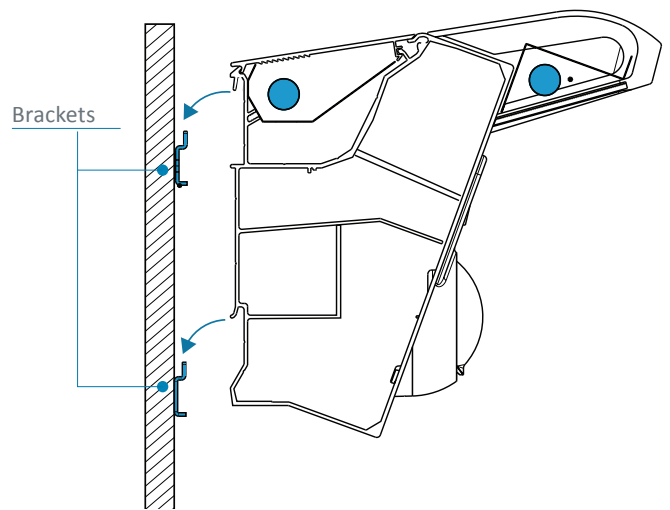

Electrical equipment integration

The waterjet cutting of the Medissima's cover enables exact and customized cutting. It can integrate all forms of outlets. Flush mounting of electrical equipment enables easier cleaning and disinfection of the product.



Medical gas casing

The ABS/PC medical gas casing are available with flap (A), or without flap (B). They enable the integration of all gas outlet type (AFNOR, DIN, BS...).



CONTROLLED LIGHTING

Its optical design allows perfect control of the lighting, favouring the well-being of care teams and patients.

Efficient lighting

The reflectors provide high output and focus the light.

Comfortable lighting

Reading lighting is provided with an anti glare effect diffuser.

Controlled and directed lighting

General lighting includes a diffuser with prism which directs the luminous flux toward the center of the room.

General lighting

- Extruded PMMA* diffuser with asymmetric grooves
- MIRO 20 SILVER® aluminum reflector

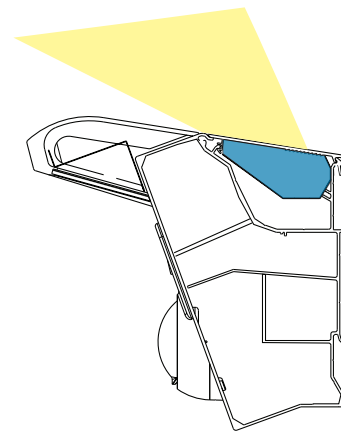

Reading lighting

- Pressed PMMA* micro-prismatic diffuser
- MIRO 20 SILVER® aluminum reflector

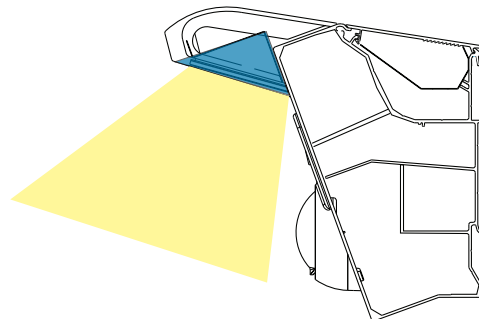

Caring lighting

Caring lighting combines direct (reading) lighting with indirect (general) lighting.

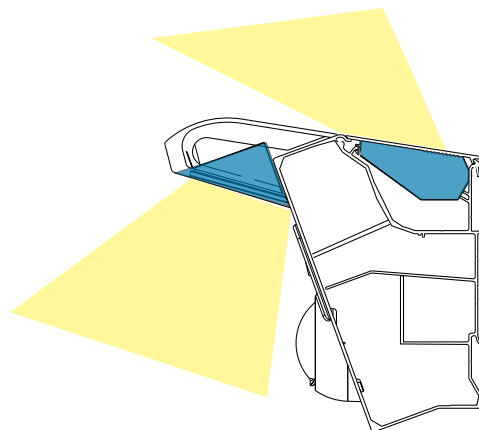

*Polymethyl Metacrylate

Lighting study

- Standard room
- Dimensions of the room: 3 m x 3 m, ceiling clearance 2.5 m
- Reflection coefficients: ceiling 7, walls 5, and floor 3
- Coefficient of depreciation 0.83

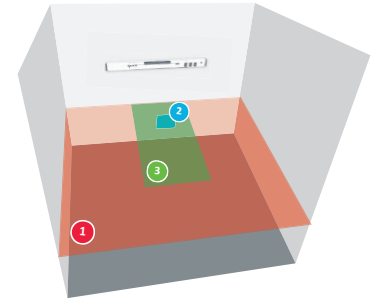

| | General lighting Virtual general lighting plane of a surface equal to the one of the room, located 0.85 m above the floor (3 m x 3 m for a single room). | Reading lighting Virtual reading plane 0.3 m x 0.3 m inclined at 75° located 1.1 m from the floor and 1 m from the wall where the unit is located. | Caring lighting Virtual examination plane 2 m x 0.9 m located 0.85 m from the floor, centred in width and 0.1 m from the wall. |
|------------------|--|--|--|
| LED | 4 ft module | 2 ft module | General and reading lighting combined |
| Consumption | 42,1 W | 16,2 W | 58,3 W |
| Average lighting | 140 lx | 326 lx | 394 lx |

Lighting power

| Lighting | Power | Types of sources | Color temperature | Luminous flux | Consumption | System Efficiency | Driver(s) |
|------------------|---------------|------------------|-------------------|---------------|-------------|-------------------|-----------------------|
| General lighting | 36,7 W (4 Ft) | LED | 3000 K 4000 K | 5674 lm | 42,1 W | 135 lm/W | Fixed / 1-10 V / DALI |
| | 45,5 W (5 Ft) | LED | 3000 K 4000 K | 7093 lm | 52,2 W | 136 lm/W | Fixed / 1-10 V / DALI |
| Reading lighting | 12,6 W (2 Ft) | LED | 3000 K 4000 K | 2120 lm | 16,2 W | 131 lm/W | Fixed / 1-10 V / DALI |
| Night light | 1 x 3,1 W | LED | 3000 K | 335 lm | 4,9 W | 68,4 lm/W | Fixed |



Norms & recommendations

- EN ISO 9001 and EN ISO 13485: Quality management systems
- CE Medical Devices Marking according to 93/42/EEC Directive
- EN ISO 11197: Medical supply units
- EN ISO 7396-1: Medical gas pipeline systems - Part 1
- European rules for caring centers lighting

Ceiling pendants, Suspended Beams & Columns, Bed head units / trunkings,
Sealed ceiling lightings, Medical gases monitoring & Biomedical Accessories

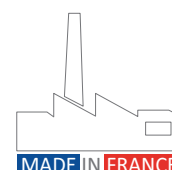

All specifications herein are provided for information purposes only and may be modified by TLV without notice.(D) - Update (JJ/MM/AA) : 09/04/2019